

# COLUMBIA BUSINESS CENTER

## LEASE – INDUSTRIAL

### Columbia Business Center

**BUILDING #2, SUITE 280**

**2119 SE Columbia Way, Vancouver WA**



- 7,883 sq. ft. total available
- Includes 1,776 sq. ft. office area
- 4 Grade level doors
- Sprinklered building
- 14' clear height
- 480 volt power

Rate: \$0.50 warehouse shell, \$0.75 office area  
Contact Dave Brown for more information

Managed By



PO Box 46  
1672 WILLAMETTE FALLS DR., STE #E  
WEST LINN, OR 97068  
PH: (503) 968-2262  
FX: (503) 650-5343



PO Box 820406  
9120 NE VANCOUVER MALL LOOP STE. 200  
VANCOUVER, WA 98682  
PH: (360) 735-8001  
FX: (360) 735-8033

**COLUMBIA COMMERCIAL PROPERTIES, LLC**

The information contained herein has been obtained from sources we deem reliable.  
We do not, however, guarantee its accuracy. All information should be verified prior to purchase or lease.

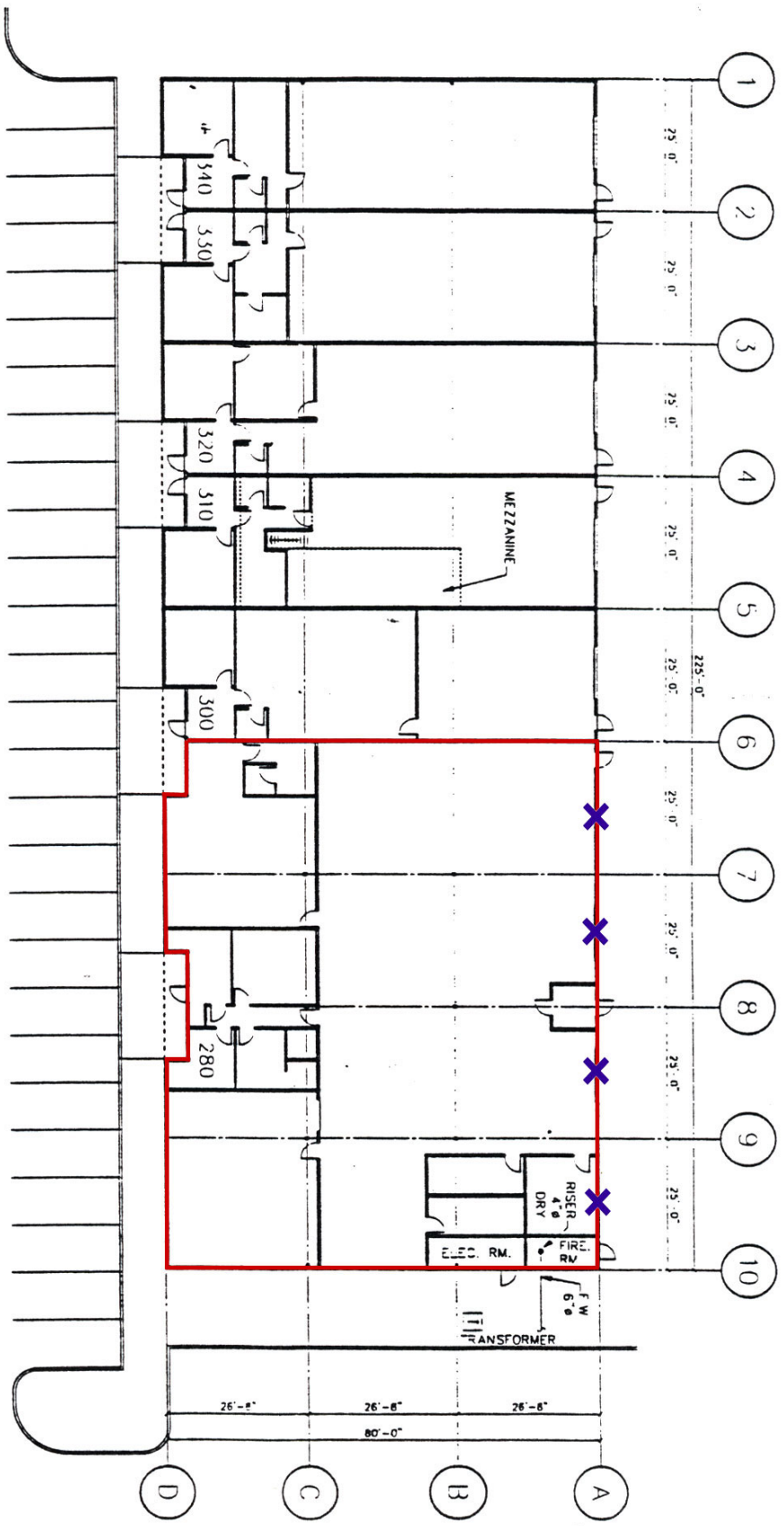

X=Grade

TRUCK MANEUVERING AREA