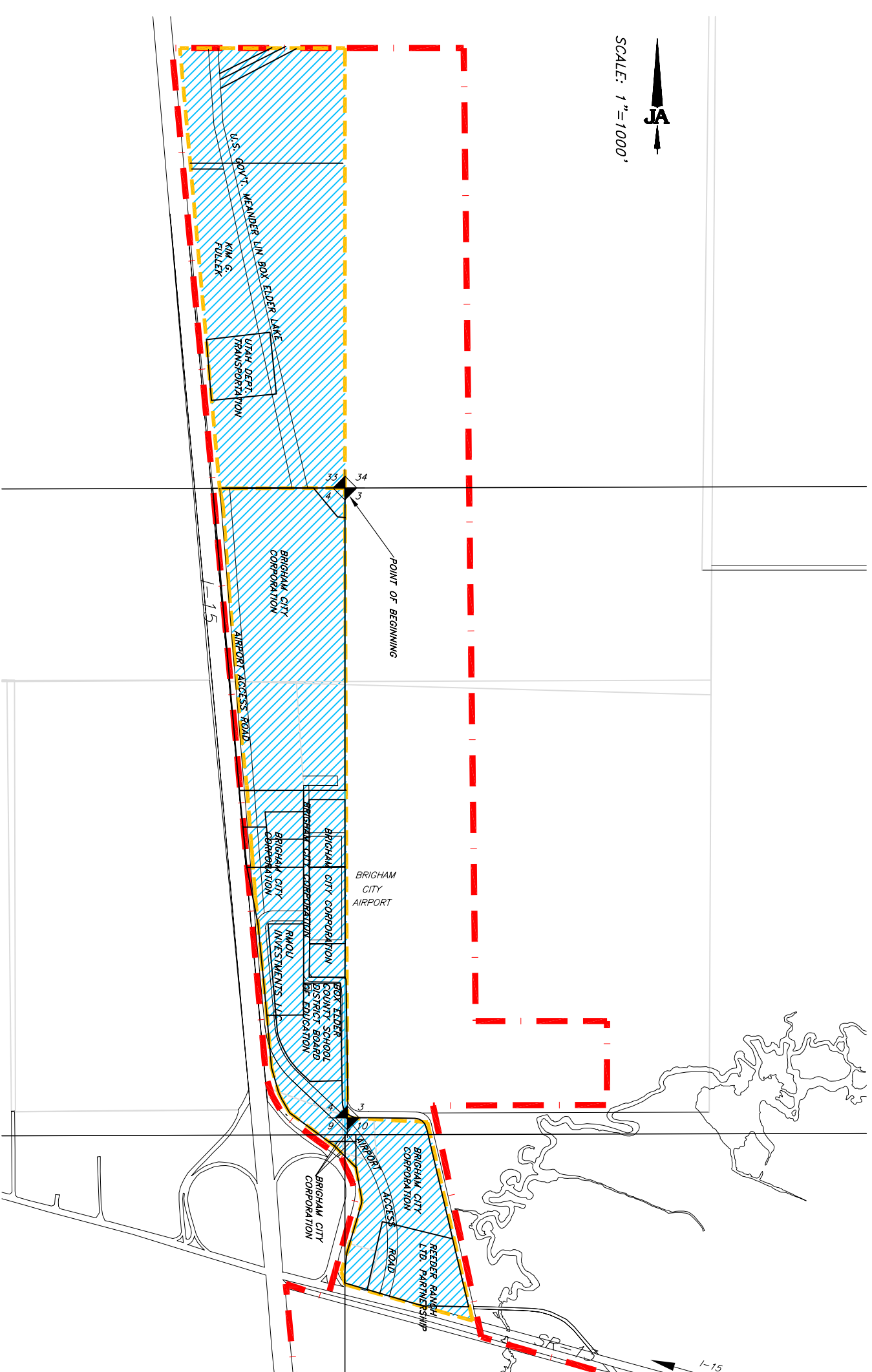

BRIGHAM CITY CORPORATION
AIRPORT
ECONOMIC DEVELOPMENT PROJECT AREA
FEBRUARY 2008

SCALE: 1" = 1000'

LEGEND

-  EDA BOUNDARY
-  BRIGHAM CITY CORPORATE CITY LIMITS

BOUNDARY DESCRIPTION

A PART OF THE EAST ½ OF SECTION 4, A PART OF THE NE ¼ OF SECTION 9, AND A PART OF THE NW ¼ OF SECTION 10, T8N, R2W, ALSO A PART OF THE EAST ½ OF SECTION 33, T10N, R2W, SALT LAKE BASE & MERIDIAN, BRIGHAM CITY, BOX ELDER COUNTY, UTAH. MORE PARTICULARLY DESCRIBED AS FOLLOWS:

BEGINNING AT THE NE CORNER OF THE ABOVE MENTIONED SECTION 4 AND RUNNING THENCE S 00°08'33" E ALONG THE EAST LINE OF SAID SECTION 4 5,196.49 FEET TO THE SE CORNER OF SAID SECTION 4; THENCE S 02°27'47" E ALONG THE EAST LINE OF SAID SECTION 9 69.58 FEET; THENCE S 89°33'58" E ALONG AN EXISTING FENCE 654.34 FEET TO THE WESTERLY LINE OF 1850 WEST STREET; THENCE S 12°07'22" E ALONG SAID WEST LINE AND AN EXISTING FENCE 1,559.05 FEET; THENCE N 89°39'57" W 190.78 FEET TO A POINT ON THE NORTH LINE OF STATE ROAD 13; THENCE N 74°02'57" W ALONG SAID NORTH LINE OF SR-13 806.16 FEET TO THE EASTERLY R/W AND N/A LINE OF INTERSTATE 15 NORTHBOUND ON RAMP, SAID POINT ALSO BEING ON THE BRIGHAM CITY CORPORATE LIMIT LINE; THENCE FOLLOWING SAID CORPORATE LIMIT LINE, AND SAID EASTERLY R/W AND N/A LINE OF I-15, (THE EAST LINE OF THE I-15 ACCESS ON RAMP AND THE EAST LINE OF THE NORTH BOUND NON-ACCESS TRAVEL LANES) THE FOLLOWING EVEN COURSES: 1) N 27°00'07" W 66.62 FEET; 2) NORTHWESTERLY ALONG THE ARC OF A 151.82 FOOT RADIUS CURVE TO THE RIGHT (RADIUS POINT BEARS N 66°06'18" E) 109.36 FEET (CHORD BEARS N 3°15'41" W 107.00 FEET); 3) N 18°43'56" E 474.22 FEET; 4) NORTHWESTERLY ALONG THE ARC OF A 404.00 FOOT RADIUS CURVE TO THE LEFT 464.62 FEET (CHORD BEARS N 17°25'41" W 439.60 FEET); 5) N 55°05'54" W 473.07 FEET; 6) N 43°46'35" W 96.08 FEET; 7) N 28°59'29" W 252.55 FEET; 8) N 5°12'38" W 545.74 FEET; 9) N 5°19'28" W 578.82 FEET; 10) N 5°16'28" W 616.32 FEET; 11) N 5°16'30" W 3,263.31 FEET TO THE NORTH AND SAID EAST LINE OF I-15 3,600 FEET MORE OR LESS TO THE NORTH LINE OF SAID CORPORATE LIMITS; THENCE EAST ALONG SAID CORPORATE LIMIT LINE 1,385.93 FEET MORE OR LESS TO THE EAST LINE OF SAID SECTION 33, AND SOUTH ALONG SAID SECTION LINE 3,590.40 FEET TO THE POINT OF BEGINNING.

CONTAINS: 220.38 ACRES

Prepared By:

